

General Trackunit DualID II installation

Placement instructions

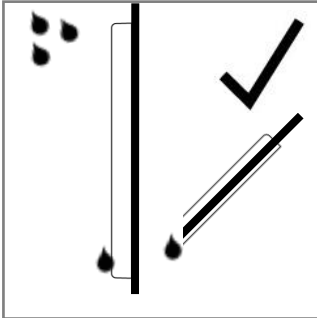

Make sure that water can run off the unit.

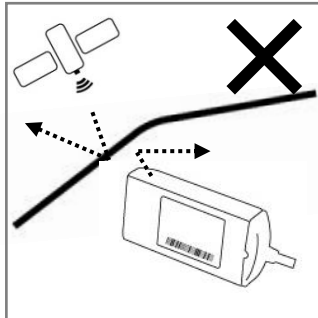

Do NOT install the GPS/GSM unit directly under a layer of metal or next to wires.

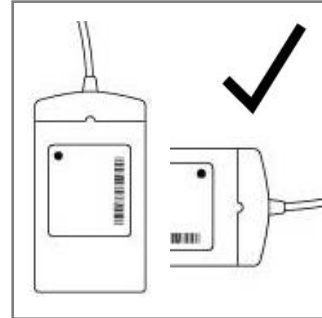

Locate the unit as shown for optimal signal conditions.

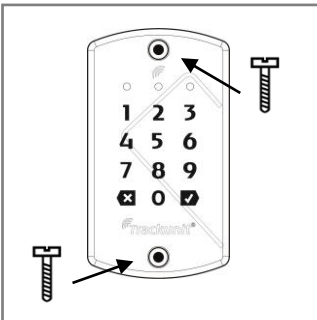

1. Mount DualID II using M4 or 5/32 inch screws.

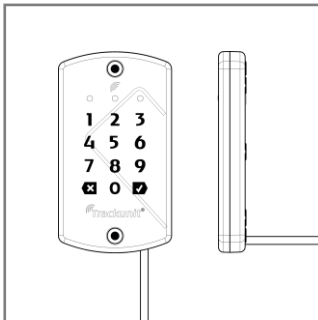

2. Cable can be installed two different ways. Cable go down or Cable go out of the rear part into a hole minimum 11mm.

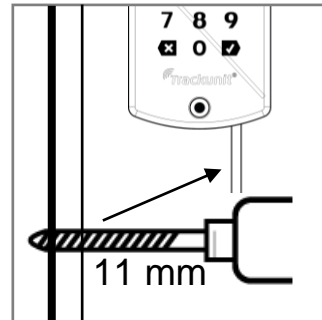

3. . Drill a hole in the back panel for the unit cable and drag the cable through the hole. The hole must be big enough for the plug!

Practical advice

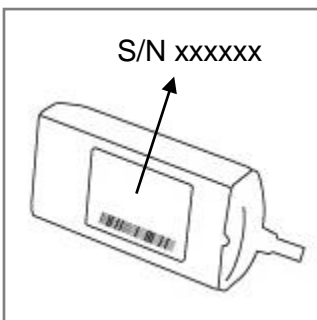

Serial number located on the back of the GPS/GSM unit.

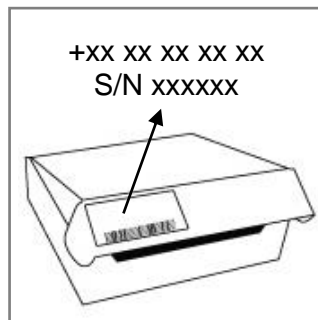

GSM number and unit serial number is located on the box. Label can be peeled off and placed on page 4 of this guide.

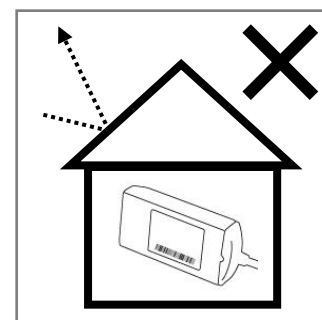

Do NOT perform installation inside a building.

Installation example

Example showing general installation

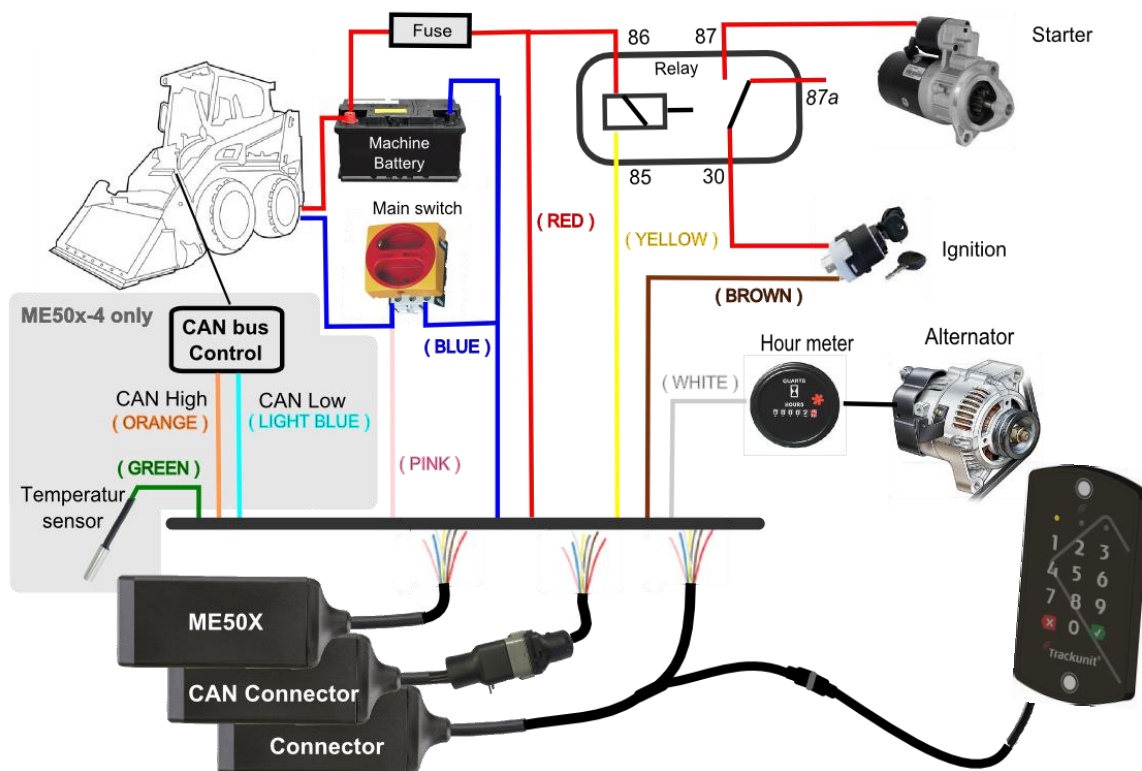

Guidelines for correct wiring:

Disconnect the power supply during installation.

Wire color	Connection	Description
Red	Power	Mandatory connected to permanent 12/24Volt supply through a 1-5A fuse
Blue	Ground	Mandatory connected to ground
White	Digital input 1	Can be connected to hour counter Optional input ^A .
Brown	Digital input 2	Connect to the ignition signal ^A . Mandatory for vehicles and machines
Grey	Digital input 3	Optional input ^A .
Pink	Digital input 4	Can be used for INFILT function Optional input ^A .
Yellow	Digital output 1	Can be used to control a relay ^{B, C} .
Green	1-Wire input	Can be connected to a 1-wire temperature sensor.
Orange	CAN High	Connect to CAN High
Light blue	CAN Low	Connect to CAN Low